

100  
0 10  
Millimetres

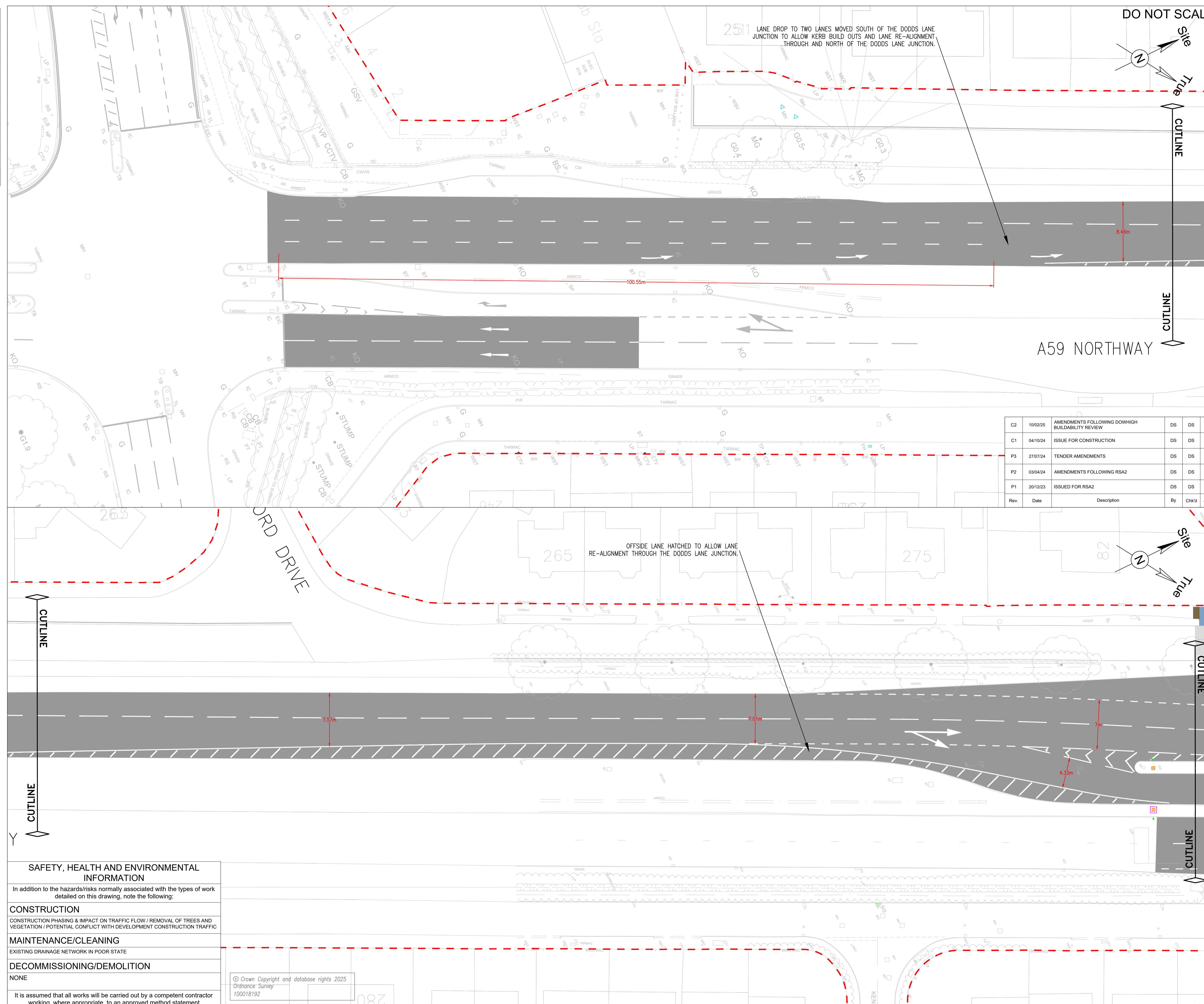

DO NOT SCALE

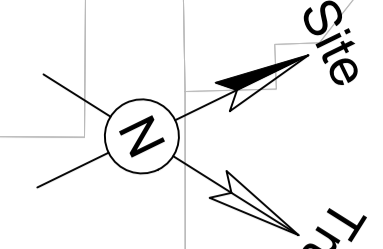

- NOTES:**
- THIS DRAWING IS INTENDED AS A GENERAL ARRANGEMENT DRAWING. REFER TO THE FULL SET OF CONSTRUCTION DRAWINGS FOR FURTHER DETAILS.
  - REFER TO THE DRAWINGS LISTED IN THE DRAWING INDEX SHEET FOR FULL CONSTRUCTION INFORMATION AND DETAILS.
  - ALL DIMENSIONS ARE IN METRES UNLESS OTHERWISE SPECIFIED.

- GENERAL KEY:**
- CONCRETE BLISTER TACTILE PAVING (RED)
  - CONCRETE BLISTER TACTILE PAVING (BUFF)
  - CONCRETE CORDUROY HAZARD PAVING (BUFF)
  - CONCRETE CYCLETRACK DIRECTIONAL PAVING (BUFF)
  - PROPOSED KERB LINE (125mm PCC)
  - PROPOSED DRAINAGE KERBS (150mm PCC)
  - PROPOSED BUS STOP ACCESS KERBS (PCC)
  - PROPOSED EDGING (PCC)
  - PCC CYCLETRACK DEMARCATION BLOCKS
  - PAVING SLAB RETAINING WALL
  - ROADMARKING TO TSRGD DIAG. NO. 956
  - WAND ORCA CYCLE SEPARATORS
  - PROPOSED DIRECTIONAL BOLLARD
  - PROPOSED OR RE-LOCATED PEDESTRIAN GUARDRAILING
  - PROPOSED TIMBER KNEE RAIL FENCING
  - PROPOSED ARMCO BARRIER
  - PROPOSED BOLLARD
  - UTILITY CHAMBER OR MANHOLE CONFLICTING WITH WORKS
  - LIGHTING COLUMN - REFER TO STREET LIGHTING DRAWINGS FOR DETAILS
  - INDICATIVE TRAFFIC SIGNALS EQUIPMENT - REFER TO TRAFFIC SIGNALS DRAWINGS FOR DETAILS
  - TRAFFIC SIGNALS CHAMBER - REFER TO TRAFFIC SIGNALS DRAWINGS FOR DETAILS
  - PROPOSED GULLY - REFER TO DRAINAGE DRAWINGS FOR CONSTRUCTION DETAIL AND CONNECTIONS / DISCONNECTIONS
  - DRAINAGE KERB OUTLET - REFER TO DRAINAGE DRAWINGS FOR CONSTRUCTION DETAIL & CONNECTIONS/DISCONNECTIONS
  - DRAINAGE CHAMBER - REFER TO DRAINAGE DRAWINGS FOR CONSTRUCTION DETAIL & CONNECTIONS/DISCONNECTIONS

- LAND & BOUNDARY KEY:**
- EXISTING HIGHWAY
  - BOUNDARY
  - DEVELOPMENT BOUNDARY
  - PROPOSED HIGHWAY
  - BOUNDARY
  - S278 WORKS BOUNDARY

- SURFACE FINISHES KEY:**
- RE-SURFACED CARRIAGEWAY
  - (ASPHALT CONCRETE 100mm PLANE, INLAY AND REGULATE)
  - PROPOSED CARRIAGEWAY CONSTRUCTION
  - (ASPHALT CONCRETE FULL DEPTH CONSTRUCTION)
  - PROPOSED AC FOOTWAY
  - (ASPHALT CONCRETE SURFACING, BINDER AND REGULATE)
  - PROPOSED AC FOOTWAY (FULL DEPTH)
  - (ASPHALT CONCRETE SURFACING, BINDER AND SUB BASE)
  - NEW AC SEGREGATED CYCLEWAY
  - (ASPHALT CONCRETE SURFACING, BINDER AND REGULATE)
  - NEW GREEN COLOURED AC CYCLEWAY
  - (GREEN ASPHALT CONCRETE SURFACING)
  - NEW SIGNALS MAINTENANCE PARKING PAD
  - (GRASSCRETE)
  - SOFT LANDSCAPING
  - (TOPSOIL AND GRASS SEED/POTENTIAL FOR PLANTING)
  - PROPOSED FILTER DRAIN
  - (REFER TO DRAINAGE DRAWINGS FOR CONSTRUCTION DETAIL)
  - EARTHWORKS (1:3) - TOPSOIL AND GRASS SEED
  - EXISTING CARRIAGEWAY
  - (NO WORKS PROPOSED)

- SIGNIFICANT ISSUE ID KEY:**
- H&S / DESIGN ISSUE
  - UTILITIES CONFLICTS
  - ENVIRONMENTAL ISSUE
  - NON HIGHWAYS LAND TAKE

Rev.	Date	Description	By	Chkd	App'd
C2	10/02/25	AMENDMENTS FOLLOWING DOWHIGH BUILDABILITY REVIEW	DS	DS	PE
C1	04/10/24	ISSUE FOR CONSTRUCTION	DS	DS	PE
P3	27/07/24	TENDER AMENDMENTS	DS	DS	PE
P2	03/04/24	AMENDMENTS FOLLOWING RSA2	DS	DS	PE
P1	20/12/23	ISSUED FOR RSA2	DS	DS	PE

**SAFETY, HEALTH AND ENVIRONMENTAL INFORMATION**

In addition to the hazards/risks normally associated with the types of work detailed on this drawing, note the following:

**CONSTRUCTION**  
CONSTRUCTION PHASING & IMPACT ON TRAFFIC FLOW / REMOVAL OF TREES AND VEGETATION / POTENTIAL CONFLICT WITH DEVELOPMENT CONSTRUCTION TRAFFIC

**MAINTENANCE/CLEANING**  
EXISTING DRAINAGE NETWORK IN POOR STATE

**DECOMMISSIONING/DEMOLITION**  
NONE

It is assumed that all works will be carried out by a competent contractor working, where appropriate, to an approved method statement

© Crown Copyright and database rights 2025  
Ordnance Survey  
100018192

Drawing Status: **ISSUE FOR CONSTRUCTION** Suitability: **A**

**SNC-LAVALIN**  
ATKINS  
Member of the SNC-Lavalin Group

ATKINS  
www.atkinsglobal.com  
© SNC-Lavalin (2025)

Client: **Sefton Council**  
Magdalen House, 30 Trinity Road, Bootle, Merseyside, L20 3NJ  
Tel: 0151 934 2000

Project Title: **A59 NORTHWAY ACTIVE TRAVEL CORRIDOR DODDS LANE TO ROBBINS ROUNDABOUT**

Drawing Title: **DETAILED DESIGN GENERAL ARRANGEMENT (Sheet 1 of 9)**

Scale	Designed	Drawn	Checked	Authorised
1:250	DS	DS	DS	PE
Original Size	Date	Date	Date	Date
A1	15/12/23	15/12/23	15/12/23	15/12/23
Drawing Number	Revision			
5214718-ATK-HGN-A59-DR-D-D101A	C02			

Internal Project Number: 5214718