

100
0 10
Millimetres

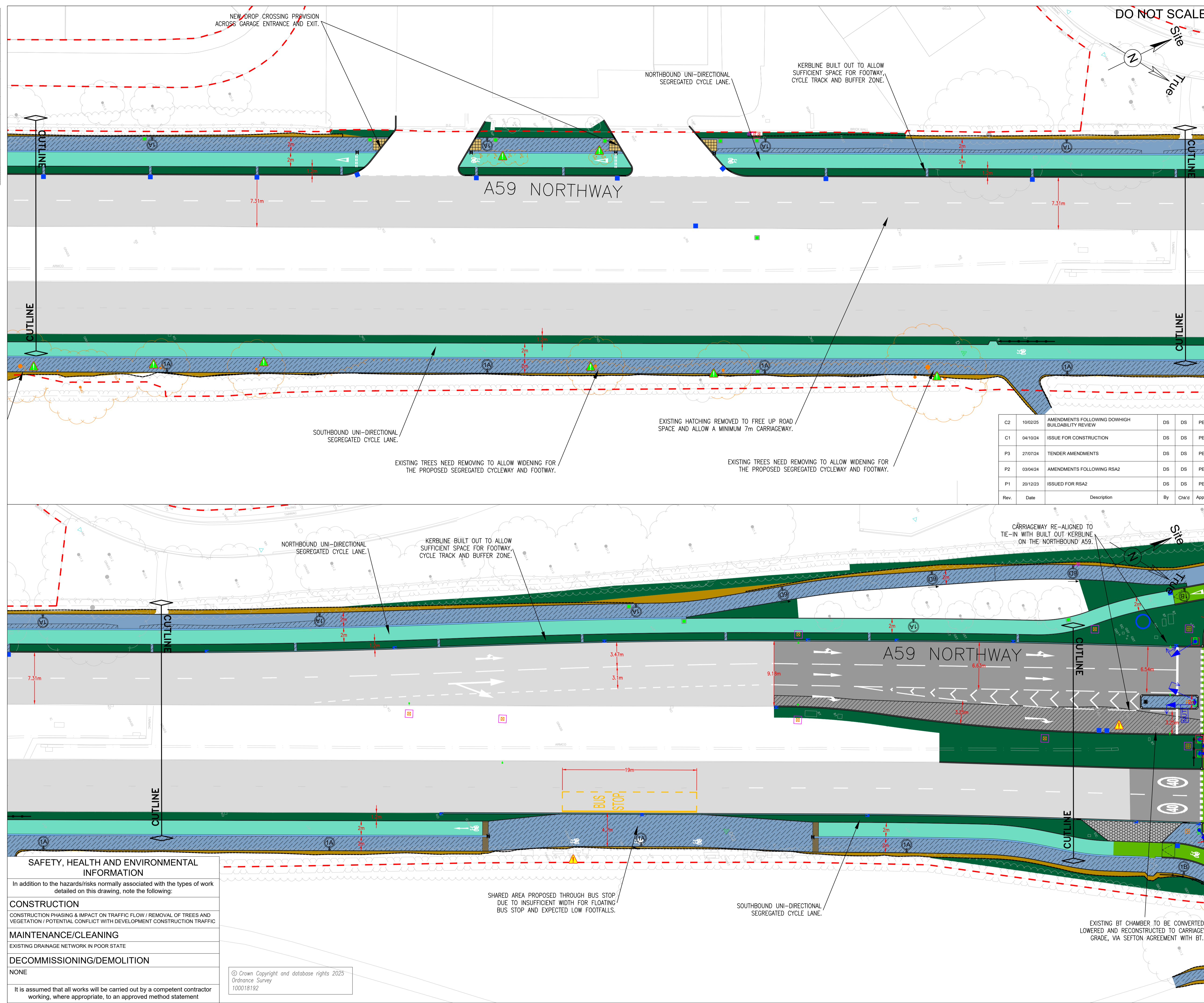

DO NOT SCALE

- NOTES:**
- THIS DRAWING IS INTENDED AS A GENERAL ARRANGEMENT DRAWING. REFER TO THE FULL SET OF CONSTRUCTION DRAWINGS FOR FURTHER DETAILS.
 - REFER TO THE DRAWINGS LISTED IN THE DRAWING INDEX SHEET FOR FULL CONSTRUCTION INFORMATION AND DETAILS.
 - ALL DIMENSIONS ARE IN METRES UNLESS OTHERWISE SPECIFIED.

- GENERAL KEY:**
- CONCRETE BLISTER TACTILE PAVING (RED)
 - CONCRETE BLISTER TACTILE PAVING (BUFF)
 - CONCRETE CORDUROY HAZARD PAVING (BUFF)
 - CONCRETE CYCLETRACK DIRECTIONAL PAVING (BUFF)
 - PROPOSED KERB LINE (125mm PCC)
 - PROPOSED DRAINAGE KERBS (150mm PCC)
 - PROPOSED BUS STOP ACCESS KERBS (PCC)
 - PROPOSED EDGING (PCC)
 - PCC CYCLETRACK DEMARCATION BLOCKS
 - PAVING SLAB RETAINING WALL
 - ROADMARKING TO TSRGD DIAG. NO. 956
 - WAND ORCA CYCLE SEPARATORS
 - PROPOSED DIRECTIONAL BOLLARD
 - PROPOSED OR RE-LOCATED PEDESTRIAN GUARDRAILING
 - PROPOSED TIMBER KNEE RAIL FENCING
 - PROPOSED ARMO BARRIER
 - PROPOSED BOLLARD
 - UTILITY CHAMBER OR MANHOLE CONFLICTING WITH WORKS
 - LIGHTING COLUMN - REFER TO STREET LIGHTING DRAWINGS FOR DETAILS
 - INDICATIVE TRAFFIC SIGNALS EQUIPMENT - REFER TO TRAFFIC SIGNALS DRAWINGS FOR DETAILS
 - TRAFFIC SIGNALS CHAMBER - REFER TO TRAFFIC SIGNALS DRAWINGS FOR DETAILS
 - PROPOSED GULLY - REFER TO DRAINAGE DRAWINGS FOR CONSTRUCTION DETAIL AND CONNECTIONS / DISCONNECTIONS
 - DRAINAGE KERB OUTLET - REFER TO DRAINAGE DRAWINGS FOR CONSTRUCTION DETAIL & CONNECTIONS/DISCONNECTIONS
 - DRAINAGE CHAMBER - REFER TO DRAINAGE DRAWINGS FOR CONSTRUCTION DETAIL & CONNECTIONS/DISCONNECTIONS

- LAND & BOUNDARY KEY:**
- EXISTING HIGHWAY BOUNDARY
 - DEVELOPMENT BOUNDARY
 - PROPOSED HIGHWAY BOUNDARY
 - S278 WORKS BOUNDARY

- SURFACE FINISHES KEY:**
- RE-SURFACED CARRIAGEWAY (ASPHALT CONCRETE 100mm PLANE, INLAY AND REGULATE)
 - PROPOSED CARRIAGEWAY CONSTRUCTION (ASPHALT CONCRETE FULL DEPTH CONSTRUCTION)
 - PROPOSED AC FOOTWAY (ASPHALT CONCRETE SURFACING, BINDER AND REGULATE)
 - PROPOSED AC FOOTWAY (FULL DEPTH) (ASPHALT CONCRETE SURFACING, BINDER AND SUB BASE)
 - NEW AC SEGREGATED CYCLEWAY (ASPHALT CONCRETE SURFACING, BINDER AND REGULATE)
 - NEW GREEN COLOURED AC CYCLEWAY (GREEN ASPHALT CONCRETE SURFACING)
 - NEW SIGNALS MAINTENANCE PARKING PAD (GRASSCRETE)
 - SOFT LANDSCAPING (TOPSOIL AND GRASS SEED/POTENTIAL FOR PLANTING)
 - PROPOSED FILTER DRAIN (REFER TO DRAINAGE DRAWINGS FOR CONSTRUCTION DETAIL)
 - EARTHWORKS (1:3) - TOPSOIL AND GRASS SEED
 - EXISTING CARRIAGEWAY (NO WORKS PROPOSED)

- SIGNIFICANT ISSUE ID KEY:**
- H&S / DESIGN ISSUE
 - UTILITIES CONFLICTS
 - ENVIRONMENTAL ISSUE
 - NON HIGHWAYS LAND TAKE

Rev.	Date	Description	By	Chkd	App'd
C2	10/02/25	AMENDMENTS FOLLOWING DOWHIGH BUILDABILITY REVIEW	DS	DS	PE
C1	04/10/24	ISSUE FOR CONSTRUCTION	DS	DS	PE
P3	27/07/24	TENDER AMENDMENTS	DS	DS	PE
P2	03/04/24	AMENDMENTS FOLLOWING RSA2	DS	DS	PE
P1	20/12/23	ISSUED FOR RSA2	DS	DS	PE

Drawing Status: **ISSUE FOR CONSTRUCTION** Suitability: **A**

SNC-LAVALIN
ATKINS
Member of the SNC-Lavalin Group

ATKINS
2nd FLOOR
THE EXCHANGE
3 NEW YORK STREET
MANCHESTER
M1 4HN
www.atkinsglobal.com
© SNC-Lavalin (2025)

Sefton Council
Magdalen House, 30 Trinity Road, Bootle, Merseyside, L20 3NJ
Tel: 0151 934 2000

Project Title: **A59 NORTHWAY ACTIVE TRAVEL CORRIDOR DODDS LANE TO ROBBINS ROUNDABOUT**

Drawing Title: **DETAILED DESIGN GENERAL ARRANGEMENT (Sheet 3 of 9)**

Scale	Designed	Drawn	Checked	Authorised
1:250	DS	DS	DS	PE
Original Size	Date	Date	Date	Date
A1	15/12/23	15/12/23	15/12/23	15/12/23
Drawing Number	Revision			
5214718-ATK-HGN-A59-DR-D-D101C	C02			

SAFETY, HEALTH AND ENVIRONMENTAL INFORMATION

In addition to the hazards/risks normally associated with the types of work detailed on this drawing, note the following:

CONSTRUCTION
CONSTRUCTION PHASING & IMPACT ON TRAFFIC FLOW / REMOVAL OF TREES AND VEGETATION / POTENTIAL CONFLICT WITH DEVELOPMENT CONSTRUCTION TRAFFIC

MAINTENANCE/CLEANING
EXISTING DRAINAGE NETWORK IN POOR STATE

DECOMMISSIONING/DEMOLITION
NONE

It is assumed that all works will be carried out by a competent contractor working, where appropriate, to an approved method statement

© Crown Copyright and database rights 2025
Ordnance Survey
100018192

SHARED AREA PROPOSED THROUGH BUS STOP DUE TO INSUFFICIENT WIDTH FOR FLOATING BUS STOP AND EXPECTED LOW FOOTFALLS.

SOUTHBOUND UNI-DIRECTIONAL SEGREGATED CYCLE LANE.

EXISTING BT CHAMBER TO BE CONVERTED LOWERED AND RECONSTRUCTED TO CARRIAGEWAY GRADE, VIA SEFTON AGREEMENT WITH BT.

Internal Project Number: 5214718